

P/2018/00530
Received 7/11/2018
REVISED PLAN

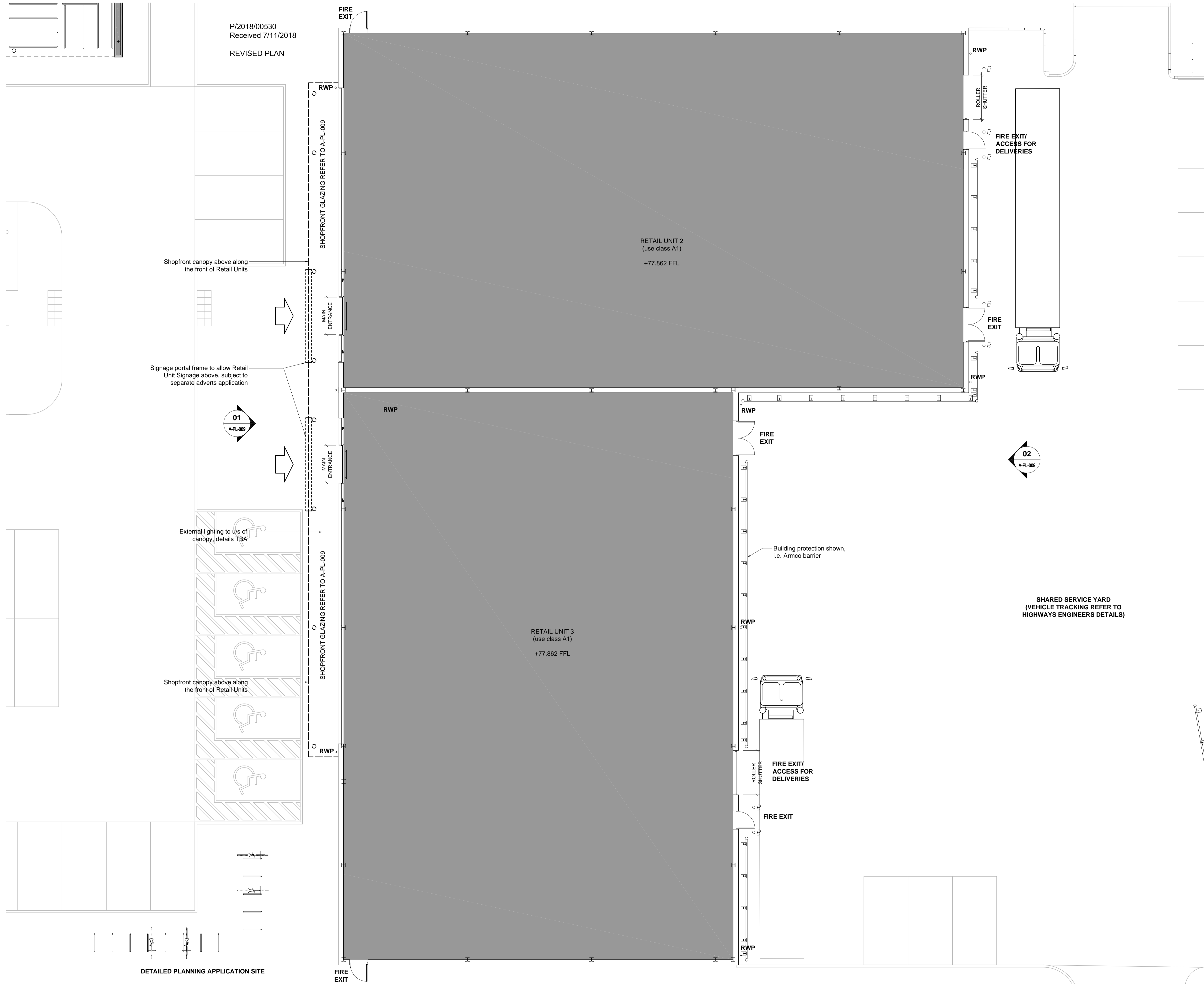

NOTES:
THIS DRAWING IS STRICTLY NOT TO BE USED FOR CONSTRUCTION PURPOSES.
PROPOSED LEVELS SUBJECT TO DESIGN DEVELOPMENT.
DRAINAGE STRATEGY & RAIN WATER PIPES SUBJECT TO DESIGN DEVELOPMENT.
THIS DRAWING CONSISTS OF THE FOLLOWING THIRD PARTY INFORMATION & DRAWINGS:-
Ordnance Survey, (c) Crown Copyright 2015. All rights reserved. Licence number 10006297
Topographical Survey by Green Hatch, drawing 15541a_OGL, received via email on 27/07/2017.
TO BE READ IN CONJUNCTION WITH HCD DRAWINGS:
A-PL-001 - SITE LOCATION PLAN
A-PL-002 - EXISTING SITE
A-PL-003 - PROPOSED SITE PLAN
A-PL-004 - PROPOSED STORE PLAN
A-PL-005 - PROPOSED STORE ROOF PLAN
A-PL-007 - PROPOSED RETAIL UNIT ROOF PLAN
A-PL-008 - PROPOSED STORE ELEVATIONS
A-PL-009 - PROPOSED RETAIL UNIT ELEVATIONS
A-PL-010 - PROPOSED SITE SECTIONS

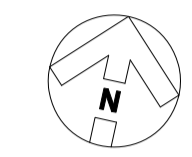
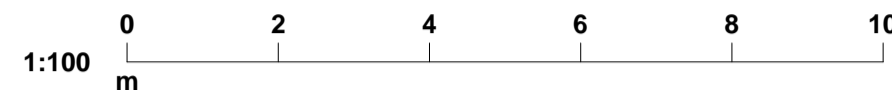

Outline Planning Application Boundary Only

REVISION	BY	CHECKED	DATE
REVISION C	By: DJW	CHECKED:	DATE: 06/08/2018
FFL raised to +77.862 following Local Authority comments on flood levels.			
REVISION B	By: DJW	CHECKED:	DATE: 09/04/2018
Scale of drawing changed to 1:100.			
REVISION A	By: DJW	CHECKED:	DATE: 28/11/2017
Issued for Planning, Red Line Boundaries Updated. Increase in Cycle storage for Retail Units.			
REVISION *	By: DJW	CHECKED:	DATE: 15/11/2017
Issued for Planning.			

PLANNING

PLOT DATE:



CLIENT:
LiDL UK GmbH
BROOKSIDE ROAD
UTTOXETER

PROJECT:
PROPOSED RETAIL UNITS
GA PLAN

DRAWING: DRAWN BY: DJW SCALE: 1:100 @ A1 DATE: NOV 2017

Hadfield Cawkwell Davidson
Broomgrove Lodge, 13 Broomgrove Rd, Sheffield, S10 2LZ T 0114 266 8181 www.hcd.co.uk

Architecture | Engineering | Interior Design | Masterplanning | Urban Design
JOB NO: 2017-119 | DRAWING NO: A-PL-005 | C
S:\Architecture\2017-119\Drawings\DK - PlansheetA-PL-005_Proposed Retail Units Building Plan.dwg HCD

DETAILED PLANNING APPLICATION SITE

OUTLINE PLANNING APPLICATION

77.61

77.57